

Description

Duct temperature sensor is used for temperature measuring in air ducts for heating, ventilation and air conditioning plants. NTC thermistor is applied as sensing element (passive element)..



Types

Probe length L = 220 mm	KTS - 1
Probe length L = 450 mm	KTS - 1 - 450
Probe length L = xxx mm	KTS - 1 - xxx

Technical data

Type of sensing element	NTC Thermistor
Measuring range	-40°C ... + 60°C
Nominal resistance value	2,2 kΩ (T = 25°C)
Degree of protection	IP 65 (EN 60529)
Housing material	AlSi12
Tube material	Brass
Cable inlet	Pg 11
Power supply	5 V DC ±(0,15 + 0,2%)

Mounting instructions

Duct temperature sensor KTS-1 should be mounted in the middle of the air ducts. Duct flange is fitting on the air ducts by meaning of two screws through Ø3,2mm holes on the duct flange. In the case of horizontal fitting, cable connection must be faced down. If the sensor has already been fitted, sensing element could be replaced without removing the whole sensor. Connection terminals are for wires up to 1,5mm² according to wiring diagram through Pg 11 cable screw fitting. The maximum wire length is 100m.

Measurements

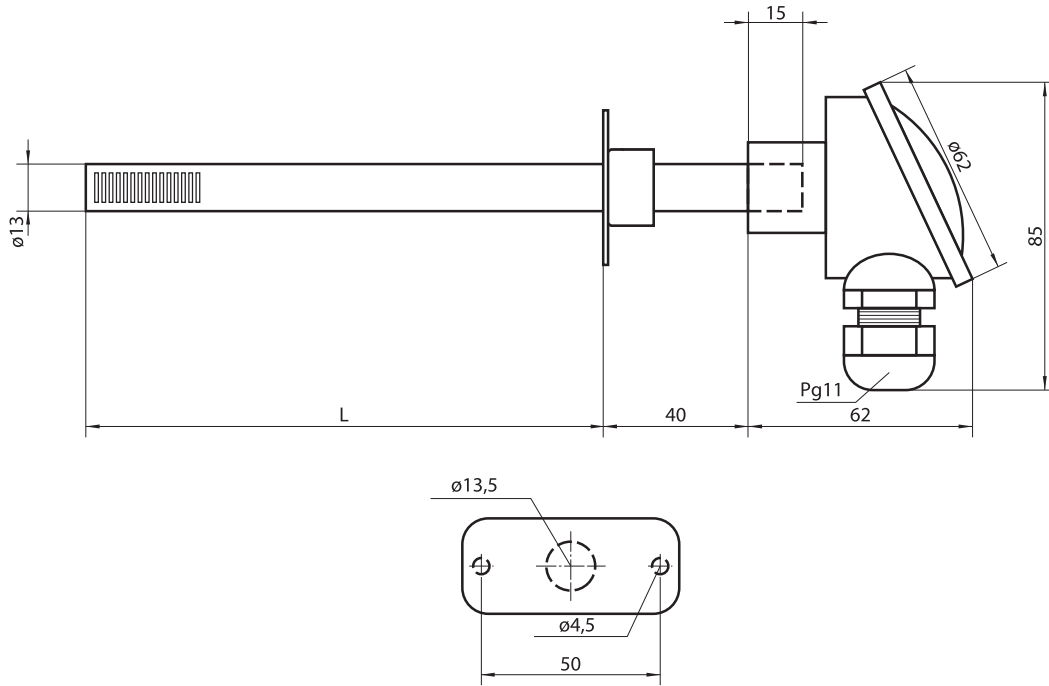

Wiring diagram

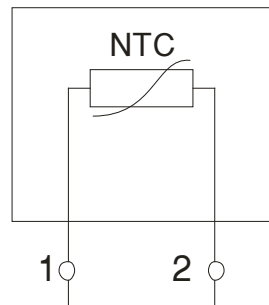

Before disposal the product must be dismantled into groups of structural components and delivered to authorized waste recycling organizations in order to preserve the environment. Local legislations must be obeyed when disposing of the components.

Feniks BB reserves the right to alter its products without notice.

All trademarks in this material are property of the respective companies. Feniks BB and Feniks BB logotype are trademarks of Feniks BB



Toponički put bb, 18202 Niš, Serbia
 tel: (018) 45-75-333, 45-75-556
 fax: (018) 45-75-557

www.feniksbb.com
info@feniksbb.com



Feniks BB has implemented and maintains quality and environment management systems in accordance with international standards ISO9001:2008 and ISO14001:2004.